

Excel Settings for R12 –WebADI, SplashXL and More4Apps

This document details the steps needed to allow you to view output of FSG, WebADI and More4Apps in Microsoft Excel.

1. Click on **File** and the **Options**

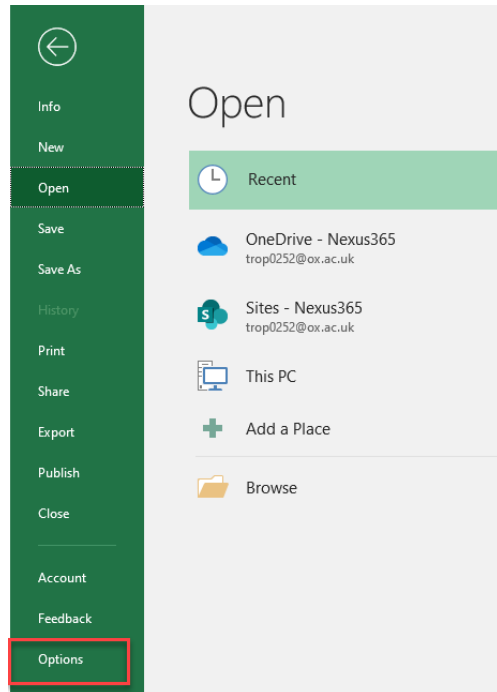

2. Click on **Trust Center**

3. Click on the **Trust Center Settings** button

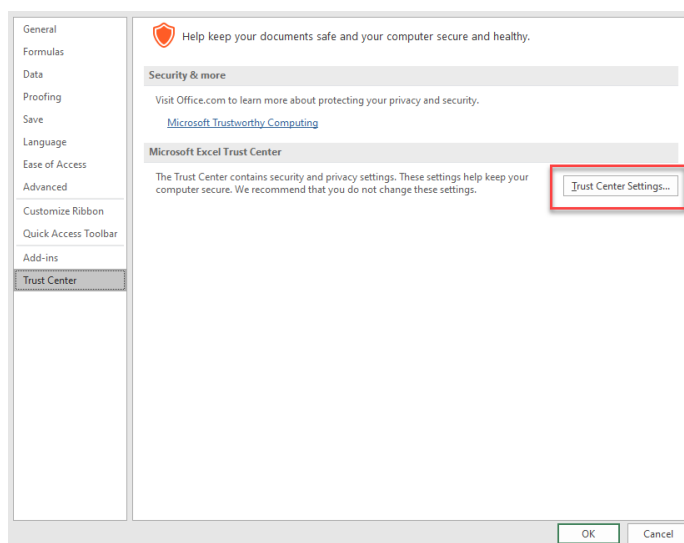

4. Click on **ActiveX Settings**.

5. If not already selected, click on the *Prompt me before enabling all controls with minimal restrictions* radio button
6. Ensure that the *Safe mode (helps limit the control's access to your computer)* checkbox is ticked.

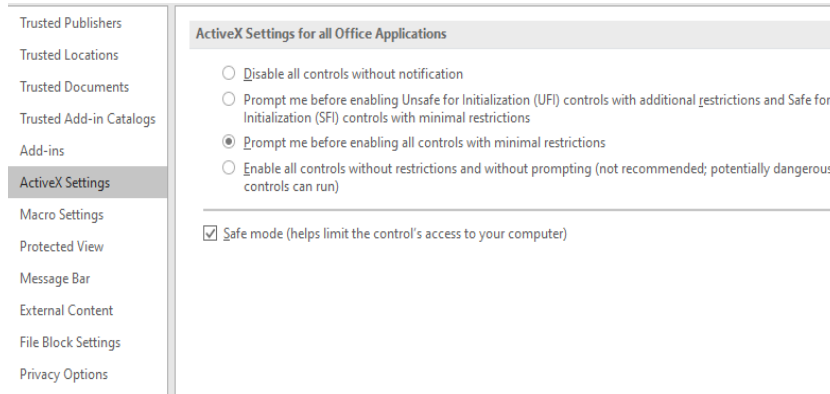

7. Click on **Macro Settings** and ensure the Trust access to the VBA project model checkbox is ticked.

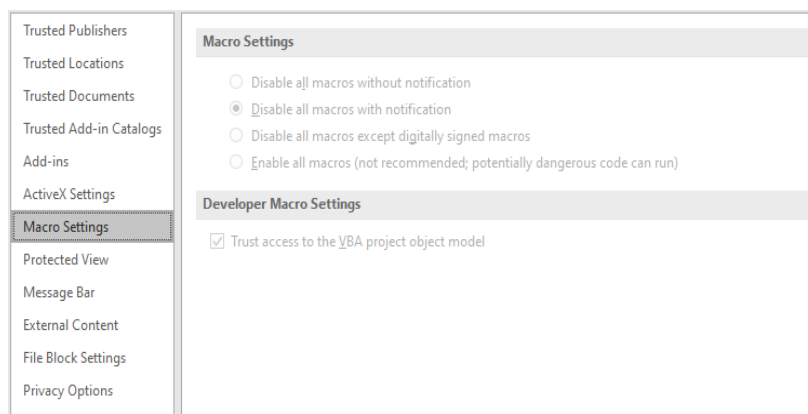

8. Click on **Protected View** settings.
9. Ensure all of the options are checked, where possible.
10. Shutdown all instances of Excel before trying to create the WebADI document, run SplashXL or using a More4Apps template.